

# Trimble HPS2 Handle

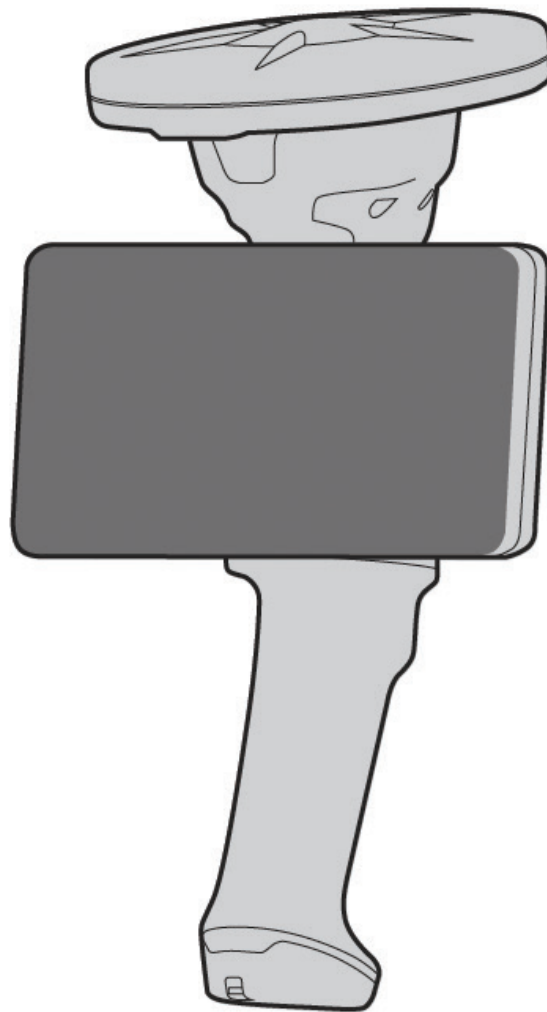

**CAUTION** – Before using this product, refer to the HPS2 Handle compliance information online.

## In the case

- ▶ Trimble® HPS2 handle
- ▶ Pole mounting bracket
- ▶ Sunshade attachment
- ▶ Batteries (x 2)
- ▶ Battery charger
- ▶ Steel mounting plates (x2)
- ▶ Wrist strap
- ▶ QR code card

## Charge and insert the battery

1. Charge the battery for 6 hours using the charging kit.

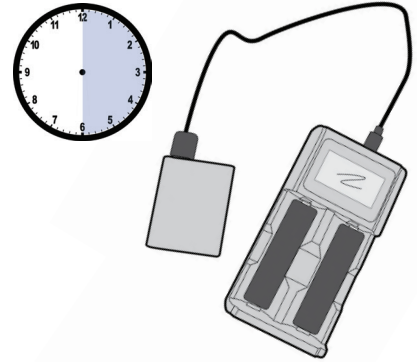

**CAUTION** – Do not charge the battery in temperatures below 0 °C (32 °F) or above 40 °C (104 °F).

2. Remove the cover from the battery cavity at the base of the HPS2 handle. Insert a fully charged battery, then replace the cover.

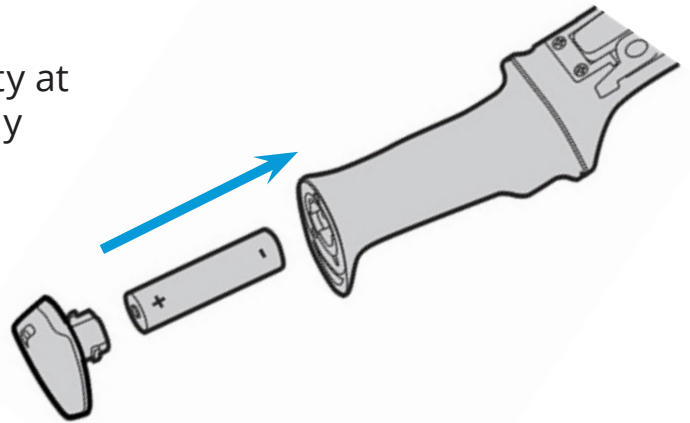

## Attach the wrist strap

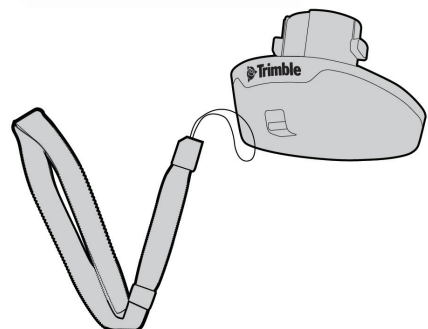

## Attach a mounting plate to your device

To easily attach and detach your device from the HPS2 handle, attach a mounting plate to your device.

**TIP** - If preferred, place your device in a rugged case before attaching the mounting plate.

1. With the adhesive covering on the mounting plate facing upward, attach a mounting plate to the magnets on the HPS2 handle.
2. Before you remove the adhesive covering on the mounting plate, place your device on top of the mounting plate and check that the mounting plate will be attached to your device in the correct place. Make sure the device will sit flat on the HPS2 handle, you can see the screen clearly, and the device's camera is visible and not obstructed by the DA2 receiver or the handle.
3. Remove your device, then remove the adhesive covering on the mounting plate.
4. Reposition your device over the mounting plate on the HPS2 handle and press down for a few seconds so the contact adhesive on the mounting plate can bond with the device.

To detach the device from the HPS2 handle, lift off the device with a twisting motion. The device, with the mounting plate fixed to it, detaches from the magnets on the HPS2 handle.

To reattach the device, position the device over the magnets on the HPS2 handle. The mounting plate on the back of the device will connect with the magnets with an audible click.

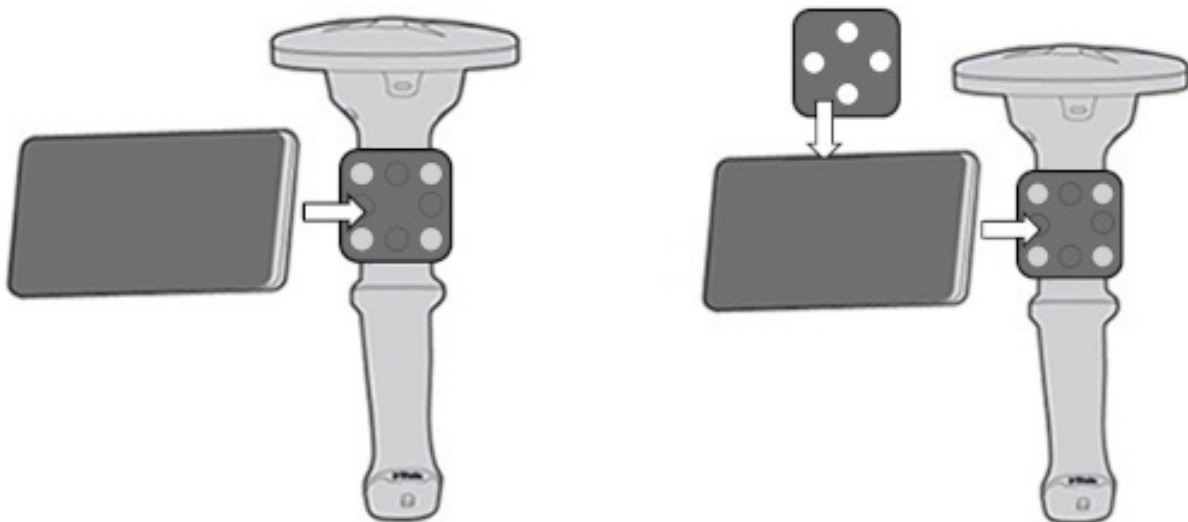

## Connect your device and the HPS2 handle

Connect your device and the HPS2 handle using Bluetooth wireless technology.

In the Bluetooth settings on your device, pair with DA2, ###: Trimble.

### Power on

- No light = Off
- **Green** = Good battery charge
- **Blue** = Electronic Distance Measure (EDM) connected
- **Flashing red** = Low battery charge
- **Solid red** = Battery charge critically low

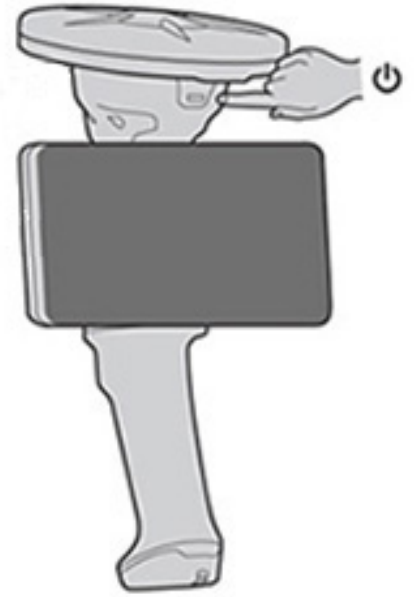

### Safety notices

The Trimble HPS2 is a Class 2 laser product.

The instrument contains visible laser sources. The product has been tested and found to comply with IEC 60825-1:2014, and 21 CFR 1040.10 and 1040.11, except for deviations pursuant to Laser Notice no.56, dated May 08, 2019.

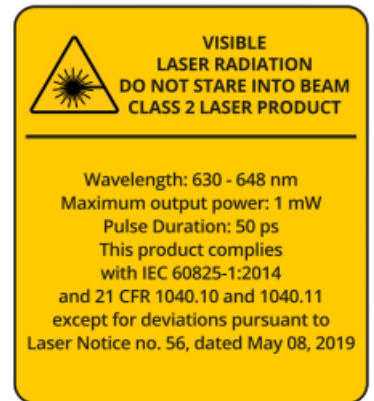

**CAUTION** – Use of controls or adjustments or performance of procedures other than those specified in the product user documentation may result in hazardous radiation exposure.



Use of the Made for Apple badge means that an accessory has been designed to connect specifically to the Apple product(s) identified in the badge and has been certified by the developer to meet Apple performance standards. Apple is not responsible for the operation of this device or its compliance with safety and regulatory standards.

Apple, iPad, and iPhone are trademarks of Apple Inc., registered in the U.S. and other countries and regions



Google Play and the Google Play logo are trademarks of Google LLC.

© 2024, Trimble Inc. All rights reserved. Trimble and the Globe & Triangle logo are trademarks of Trimble, registered in the United States and in other countries. Google, Google Play and other marks are trademarks of Google LLC. All other trademarks are the property of their respective owners. Rev A (08/2024).

Trimble Inc.  
10368 Westmoor Drive  
Westminster CO 80021  
USA